

# MOHS-C Cleanroom / Vacuum / Heat Resistant Coupling - Oldham Type (VESPEL) - Clamping Type

[WEB Selection Tool](#)
[WEB CAD Download](#)
[Cleanroom](#)
[Electrical Insulation](#)
[Heat-resistance](#)
[Chemical-proof](#)
[High Allowable Misalignment](#)

MOHS-C

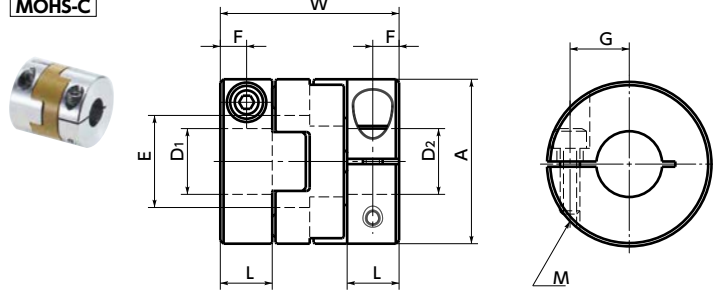

## Dimensions

Unit : mm

Part Number	A	L	W	E	F	G	M	Screw Tightening Torque (N·m)
<b>MOHS-19C</b>	19	7	22.1	10	3.5	6.5	M2.5	0.5
<b>MOHS-26C</b>	25.4	8	27.2	14	4	9	M3	0.7
<b>MOHS-32C</b>	31.7	10	33.3	18	5	11	M4	1.2

Part Number	Standard Bore Diameter							
	D1 · D2	5	6	8	10	11	12	14
<b>MOHS-19C</b>		●	●	●				
<b>MOHS-26C</b>				●	●			
<b>MOHS-32C</b>				●	●	●	●	●

- All products are provided with hex socket head cap screw.
- Recommended dimensional allowances of applicable shaft diameter are h6 and h7.
- In case of mounting on D-cut shaft, be careful about the position of the D-cut surface of the shaft. → P.258

## Performance

Part Number	Max. Bore Diameter (mm)	Rated*1 torque (N·m)	Max.*1 torque (N·m)	Max. Rotational Frequency (min <sup>-1</sup> )	Moment*2 of Inertia (kg·m <sup>2</sup> )	Static Torsional Stiffness (N·m/rad)	Max. Lateral Misalignment (mm)	Max. Angular Misalignment (°)	Mass*2 (g)
<b>MOHS-19C</b>	8	0.4	0.8	900	1.4×10 <sup>-6</sup>	160	1.3	2	28
<b>MOHS-26C</b>	10	1.2	2.4	900	5.5×10 <sup>-6</sup>	220	1.5	2	61
<b>MOHS-32C</b>	14	2.2	4.4	900	1.6×10 <sup>-5</sup>	600	2	2	110

- \*1 : Correction of rated torque and max. torque due to load fluctuation is not required.
- \*2 : These are values with max. bore diameter.

- Part number specification

**MOHS-32C-10-12** (1 set)



**MOHS-SPCR** (Single Spacer)



<a href="#">Additional Keyway at Shaft Hole → P.803</a> Available / Add'l charge	<a href="#">Cleanroom Wash &amp; Packaging → P.807</a> Cleanroom washed and packed	<a href="#">Change to Stainless Steel Screw → P.805</a> Changed to the S.S. screw
---	---	--

<a href="#">MOHS-32C-10-12</a> (1 set)	<a href="#">MOHS-SPCR</a> (Single Spacer)
--	---